

a 85-67
a spine Ridge

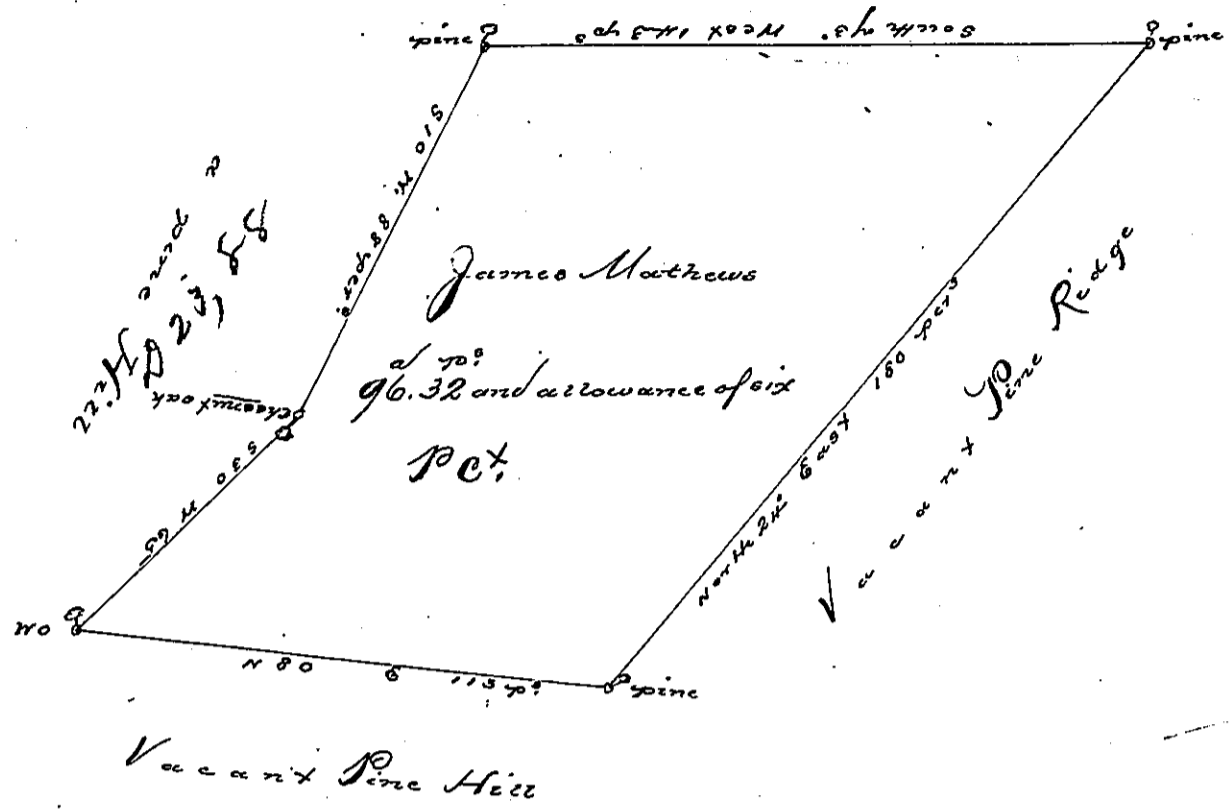

A Draught of a Tract of Land Situate on both sides of the Great Road from Cassator
 to Bedford in the County of Cumberland - containing ninety six Acres and thirty two
 perches and the usual allowance of six acres P.C. for Roads &c. Surveyed the 10th
 day of June 1765. in pursuance of a Warrant dated the seventeenth day of
 November 1762 to James Mathews

To John Lukens Surveyor General.

P Richard Neal Deputy Surveyor.

IN TESTIMONY that the above is a copy of the original remaining on file in the
 Department of Internal Affairs of Pennsylvania, made con-
 formably to an Act of Assembly approved the 16th day of
 February, 1833, I have hereunto set my Hand and caused
 the Seal of said Department to be affixed at Harrisburg, this
 sixth day of July 1897.

James W. Fortta
 Secretary of Internal Affairs.